

SPENDMORE LANE

14/00332/01

CHORLEY COUNCIL
DEVELOPMENT CONTROL

REC'D - 2 JUL 2014

PC PLAN

FILE NO. 14/00332/01

ATTEN OF

COPIES TO

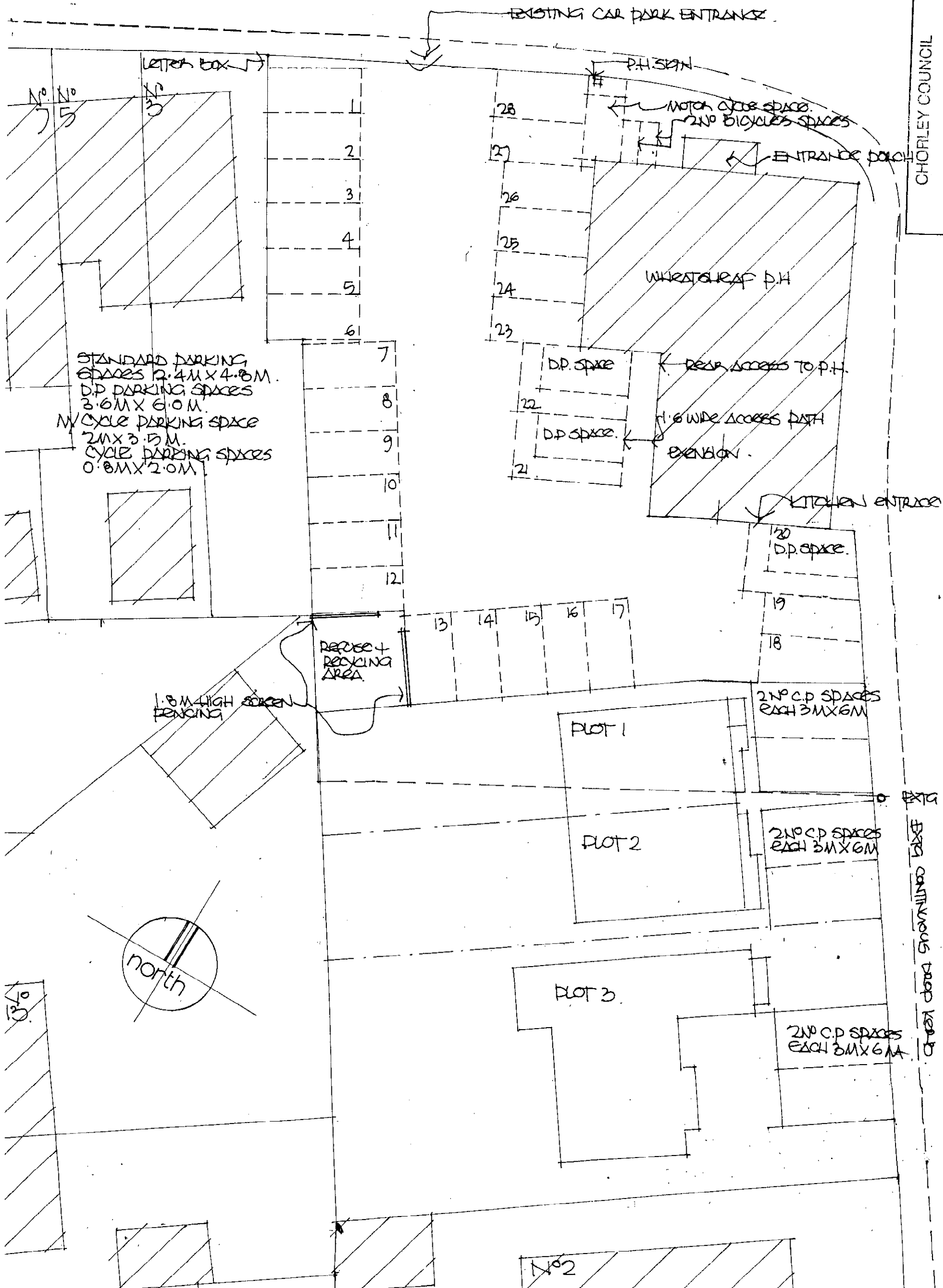

CHAPEL LANE

EXTRA LAMP POST
EXIST CONTINUOUS DRAP LEAD
CROSS CORNER

14/00332/01

(A3)

ALL SITE DEVELOPMENT PLAN 1:200

DRAWING 10/10/00